

● Replacing the tip

⚠ CAUTION
The tip may be hot. Avoid holding the hot tip for a long time even if using the heat-resistant pad. Otherwise burns may result.

Removing the tip:

- Hold down the lock release buttons in the sleeve assembly, pull out the tip together with the sleeve assembly from the connector.

⚠ CAUTION

- Be sure to keep the lock release buttons held down while pulling out the sleeve assembly. Failure to do so will damage the locking mechanism.
- Be sure to pull out the tip only after separating the sleeve assembly from the connector. Otherwise, the sleeve assembly may fall down and break.

- Holding the front end of the sleeve assembly, pull out the tip.

Inserting the tip:

Holding the front end of the tip, insert it into the sleeve assembly.

⚠ CAUTION
Insert the tip into the sleeve assembly until it clicks into place. When you hear it clicks, avoid forcing the tip into the sleeve assembly.

- Insert the tip securely into the connector.

NOTE:

If the tip is not inserted correctly, the lamp flashes red rapidly (about once every 0.2 second).

Remove the tip from the connector while pressing this part.

Hold the front part of the sleeve assembly to remove the tip.

Hold this part to insert the tip into the sleeve assembly.

Hold this part to insert the tip into the connector.

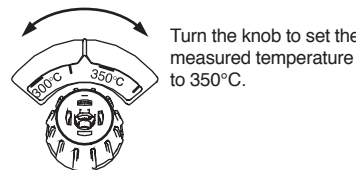
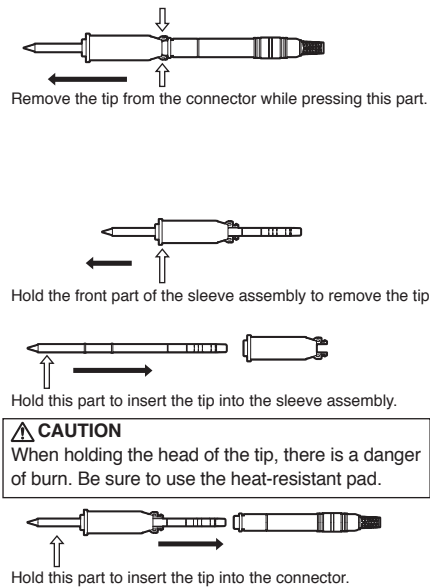

After exiting offset mode, return the knob to the first set temperature.

The iron holder (FH200-01 or FH200-02, sold separately) has a sleep function. Use the connecting cable to connect the iron holder (FH200-01 or FH200-02) to the jack at the rear of the station.

CAUTION

Be sure to turn off the power before connecting or disconnecting the connecting cable.

When the soldering iron has been in the iron holder (FH200-01 or FH200-02) for 6 minutes, the sleep function operates to start lowering the tip temperature.

When the sleep function operates, the lamp lights orange. To resume soldering, remove the soldering iron from the iron holder and then wait for 10 seconds.

NOTE:

The amount of time it takes the sleep function to start operating can't be changed.

The diagram consists of two parts. The top part shows a soldering station with a 'HAKKO' logo on its rear panel. A connecting cable is plugged into a jack on the rear. To the right, an iron holder is shown with the same connecting cable plugged into its side. A label 'Connecting cable' with arrows points to the cable in both locations. The bottom part shows a close-up of the iron holder with a soldering iron inserted into its top. An arrow points downwards from the iron holder's top, indicating the direction of heat or the iron's position.

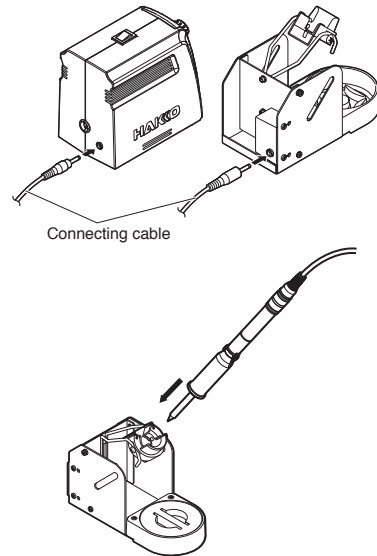

* 各言語（日本語、英語、中国語、フランス語、ドイツ語、韓国語）の取扱説明書は以下のURL、HAKKO Document Portalからダウンロードしてご覧いただけます。
 （商品によっては設定の無い言語がありますが、ご了承ください）

* 各言語（日本語、英語、中国語、フランス語、ドイツ語、韓国語）の使用説明書可以通过以下网站的HAKKO Document Portal 下载参阅。
 （有一部分的产品没有设定外语对照，请见谅）

* Instruction manual for the language, Japanese, English, Chinese, French, German and Korean can be downloaded from the following URL, HAKKO Document Portal.
 (Please note that some language may not be available depending on the product.)



<https://doc.hakko.com>