

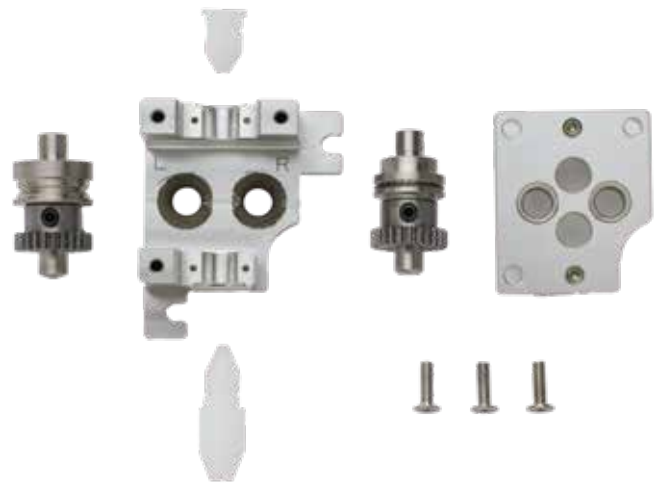

Auto-Soldering System **Separable Pulley Unit**

The pulley unit, which is the part where solder is fed while making a V-groove, needs to be regularly cleaned of solder residue and attached flux. The separable pulley unit improves maintainability by allowing disassembly and reduces running costs by replacing only the necessary parts.



Improved Points

Easy Maintenance

Driving shaft



Separable Parts

Since it can be disassembled and parts can be replaced, maintenance can be performed quickly and thoroughly, leading to stable soldering quality.

Reduction of Running Costs



Solder Wire Diameter Change

When changing the solder wire diameter, it is not necessary to replace the entire pulley unit itself, but only the individual parts can be replaced. And it is compatible with 7 kinds of solder wires which diameter is from 0.3 mm to 1.6 mm.

Pulley unit supply nozzle



Pulley unit guide nozzle



Replacement of Consumable Parts

When replacing consumable parts, it is not necessary to replace the entire pulley unit itself, but only individual parts can be replaced.