

Entering the Offset Values

The MODEL FM-202 is preset at Tip ID mode at the factory. To change into the offset values mode, refer the following process:

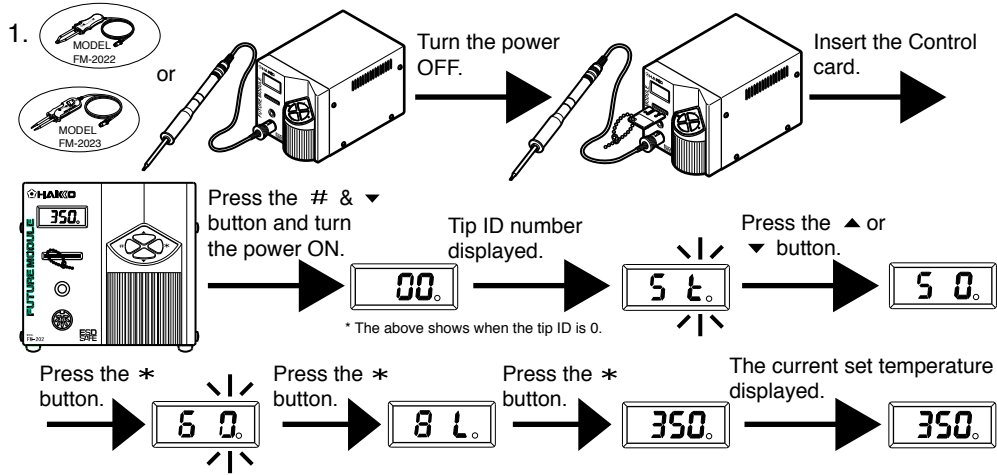

2. How to enter the tip offset value in to the MODEL FM-202.

EXAMPLE: If the measured temperature is 410°C and the set temperature is 400°C, the difference between the set temperature is -10°C. It means -10°C of the offset values have to enter.

- Insert the control card into the slot in the station. Get into the temperature setting mode. Set the temperature at 400°C and press the * button.
- Press the # button and hold for one second. Get into the offset data entry mode.
- Allow the tip to become stable, and measure the tip temperature.

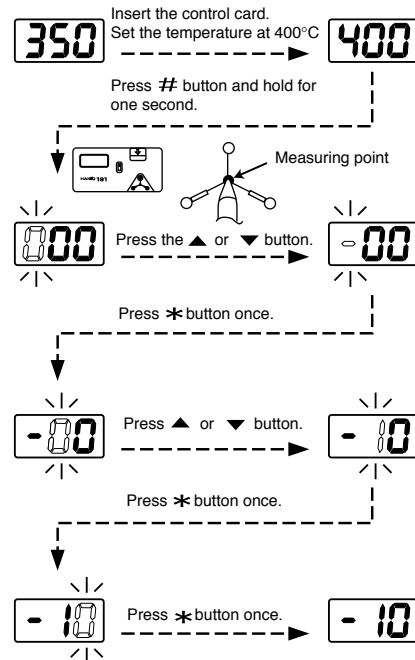

CAUTION

During offset data entry mode, the tip temperature is control using an offset value that is stored in the unit. The flashing value displayed is not meaningful.

- Enter the offset value between the tip temperature and the set temperature.

3. When change the offset values for MODE FM-2022 or MODEL FM-2023, refer to the above 1 and 2 procedure after measuring the tip temperature of either tip.

NOTE:

Once the offset values have been set, the MODEL FM-2022 or MODEL FM-2023 will be able to operate everytime.

Entering the Offset Values

The MODEL FM-202 is preset at Tip ID mode at the factory. To change into the offset values mode, refer the following process:

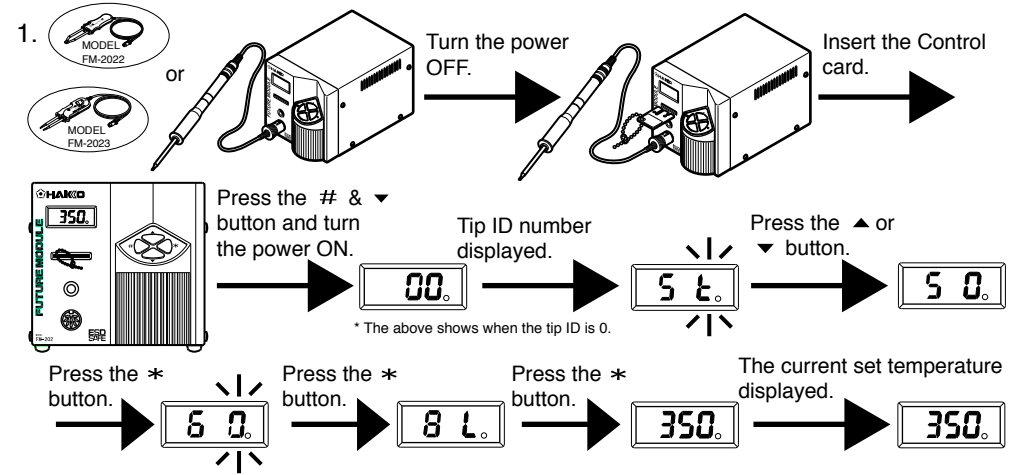

2. How to enter the tip offset value in to the MODEL FM-202.

EXAMPLE: If the measured temperature is 410°C and the set temperature is 400°C, the difference between the set temperature is -10°C. It means -10°C of the offset values have to enter.

- Insert the control card into the slot in the station. Get into the temperature setting mode. Set the temperature at 400°C and press the * button.
- Press the # button and hold for one second. Get into the offset data entry mode.
- Allow the tip to become stable, and measure the tip temperature.

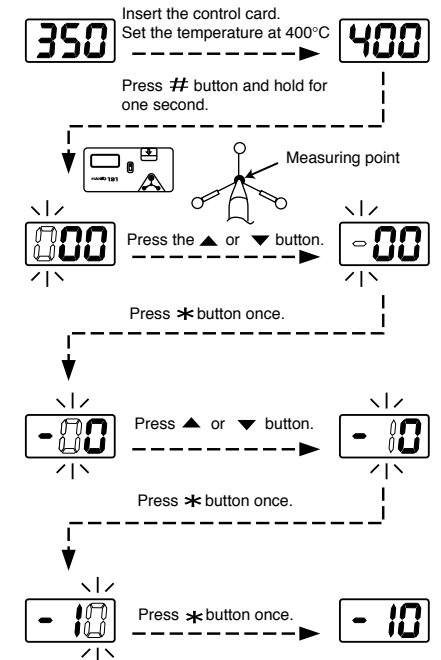

CAUTION

During offset data entry mode, the tip temperature is control using an offset value that is stored in the unit. The flashing value displayed is not meaningful.

- Enter the offset value between the tip temperature and the set temperature.

3. When change the offset values for MODE FM-2022 or MODEL FM-2023, refer to the above 1 and 2 procedure after measuring the tip temperature of either tip.

NOTE:

Once the offset values have been set, the MODEL FM-2022 or MODEL FM-2023 will be able to operate everytime.