

TIP STYLES

T2-B Shape-B

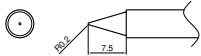

T2-2B Shape-2B

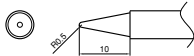

T2-1C Shape-1C

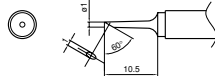

T2-4C Shape-4C
T2-4CF Shape-4C Cut-Surface Pre-tinned

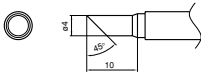

T2-1BC Shape-1BC
T2-1BCF Shape-1BC Cut-Surface Pre-tinned

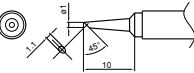

T2-2BC Shape-2BC
T2-2BCF Shape-2BC Cut-Surface Pre-tinned

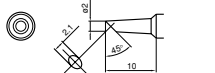

T2-3BC Shape-3BC
T2-3BCF Shape-3BC Cut-Surface Pre-tinned

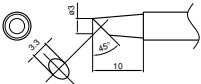

T2-08D Shape-0.8D

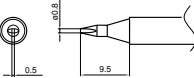

T2-12D Shape-1.2D

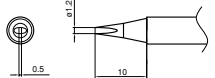

T2-16D Shape-1.6D

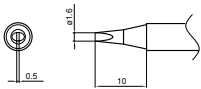

T2-24D Shape-2.4D

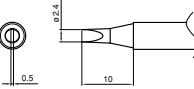

T2-4D Shape-4D

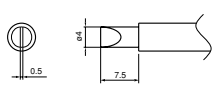

T2-32D Shape-3.2D

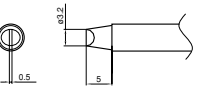

T2-52 Shape-5.2D

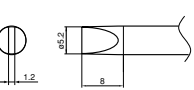

T2-1 Shape-1

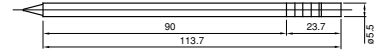
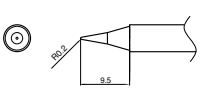

Unit: mm

T2-02J Shape-0.2R5B

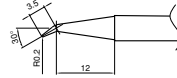

T2-02JL Shape-0.2RLB

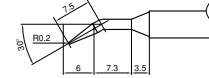

T2-02JIS Shape-0.2R5SB

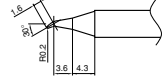

T2-K Shape-K

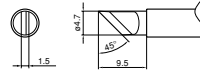

T2-KL Shape-KL

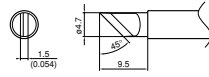

T2-KU Shape-KU

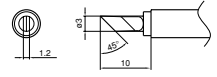

T2-LB Shape-LB

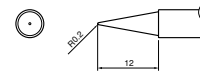

T2-08LD Shape-0.8LD

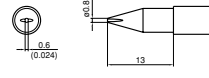

T2-12LD Shape-1.2LD

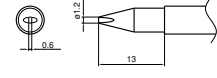

T2-LI Shape-LI

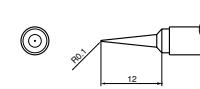

PARTS LIST

NOTE:

Spare or repair parts do not include mounting screws, if they are not listed on the description. Screws must be ordered separately.

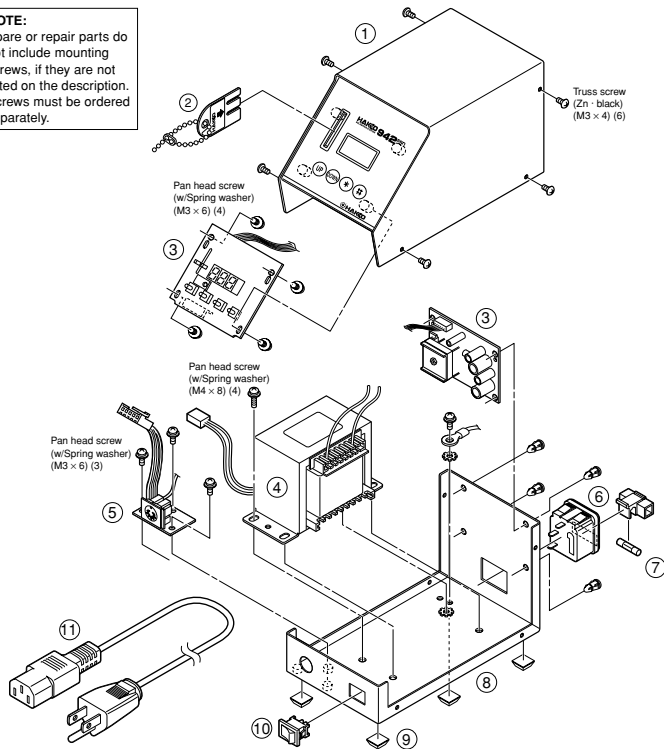

● 942 Station

Item No.	Part No.	Name	Description
1	B2579	Cover	With membrane sheet
2	B2388	Control card	
3	B2714	P.W.B. (temperature control & power supply) - 2 pcs.	100-120V
	B2813	P.W.B. (temperature control & power supply) - 2 pcs.	220-240V
4	B2662	Transformer	100-15V
	B2715	Transformer	110-15V
	B2583	Transformer	120-15V
	B2716	Transformer	220-15V
	B2717	Transformer	230-15V
5	B2582	Connector board	

Item No.	Part No.	Name	Description
6	B2666	Power receptacle	
7	B2403	Fuse, 250V-2A	100-120V
	B2404	Fuse, 250V-1A	220-240V
8	B2584	Chassis	With power receptacle, rubber feet
9	B2680	Rubber foot	4 ea.
10	B2663	Power switch	
11	B2668	Power cord, 3 core & American plug	
	B2421	Power cord, 3 core, no plug	
	B2422	Power cord, 3 core, BS plug	India
	B2436	Power cord, 3 core, CH plug	

Truss screw
(Zn - black)
(M3 × 4) (6)

Pan head screw
(w/Spring washer)
(M3 × 6) (4)

Pan head screw
(w/Spring washer)
(M4 × 8) (4)

Pan head screw
(w/Spring washer)
(M3 × 6) (3)

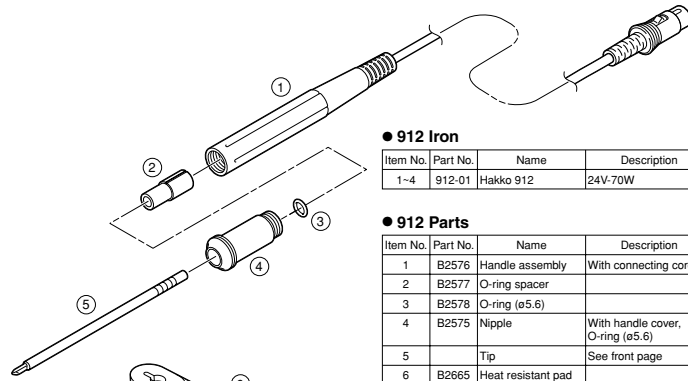

● 912 Iron

Item No.	Part No.	Name	Description
1-4	912-01	Hakko 912	24V-70W

● 912 Parts

Item No.	Part No.	Name	Description
1	B2576	Handle assembly	With connecting cord
2	B2577	O-ring spacer	
3	B2578	O-ring (ø5.6)	
4	B2575	Nipple	With handle cover, O-ring (ø5.6)
5		Tip	See front page
6	B2665	Heat resistant pad	

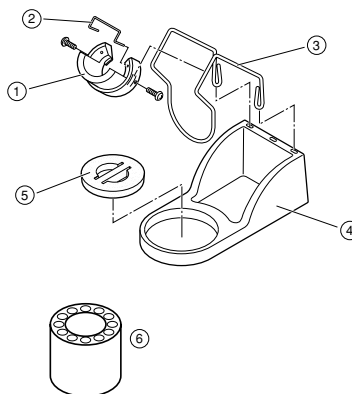

● Iron Holder

Item No.	Part No.	Name	Description
1-5	634-05	Iron holder	For HAKKO 911, 912

● Iron Holder Parts

Item No.	Part No.	Name	Description
1	B2787	Iron receptacle/Silver	With two screws for 907, 908, 911, 912, 913, 914, 953, 954, 956
2	B2791	Retaining clip	
3	B2786	Iron receptacle holder	
4	B2802	Iron holder base/Gray	With rubber foot
5	A1495	Cleaning sponge	
6	B2607	Tip tray	