

P15 MAINTENANCE/INSPECTION

Please follow the sentence below, when you read page 15 ① Open the handpiece 4, 5.

● Broken Heater or Sensor

① Open the handpiece.

1. Retract the vacuum pipe to its shortest length.
2. Remove the three screws holding the handpiece together.
3. Move the tube downward.
4. Disconnect the heater sensor connector.

⚠ CAUTION

Quartz glass and heat insulation are inside the pipe. Be careful not to drop or lose these items.

5. Remove the heating element assembly from the protruding portion of the handle.

⚠ CAUTION

Do not remove the heating element form the pipe. Do not apply excessive force to the vacuum pipe.

② Measure the resistance value.

1. Measure the resistance value (a) of the sensor. The correct value is 0 W.
2. Measure the resistance value (b) of the heater. The correct values are approximately 33W(±10%)(100-120V), 85W(±10%)(220-240V) at room temperature.

If the resistance value is incorrect, replace the part.
(Refer to the instructions included with the replacement part.)

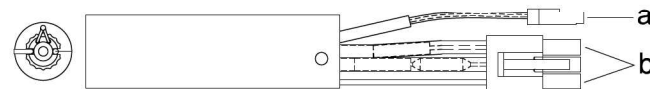
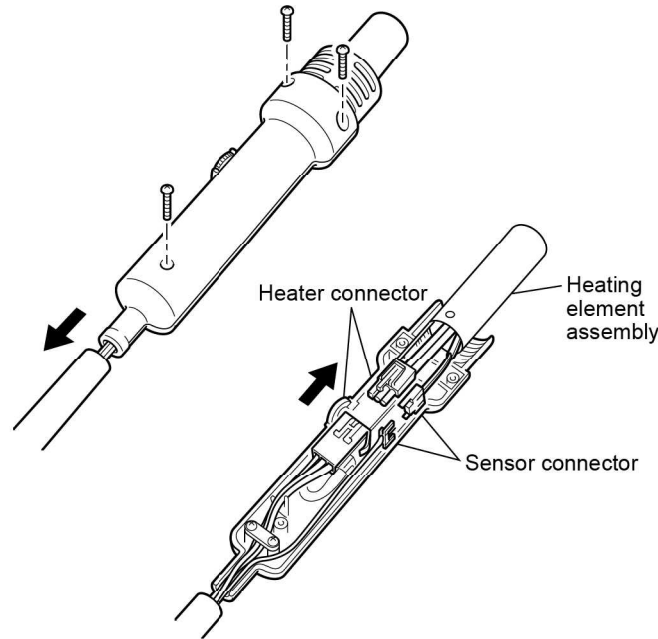

P21 PARTS LIST/HANDPIECE

When you order the replacement parts, please use the following part number.
Please affix this correction on page 21. (English Version)

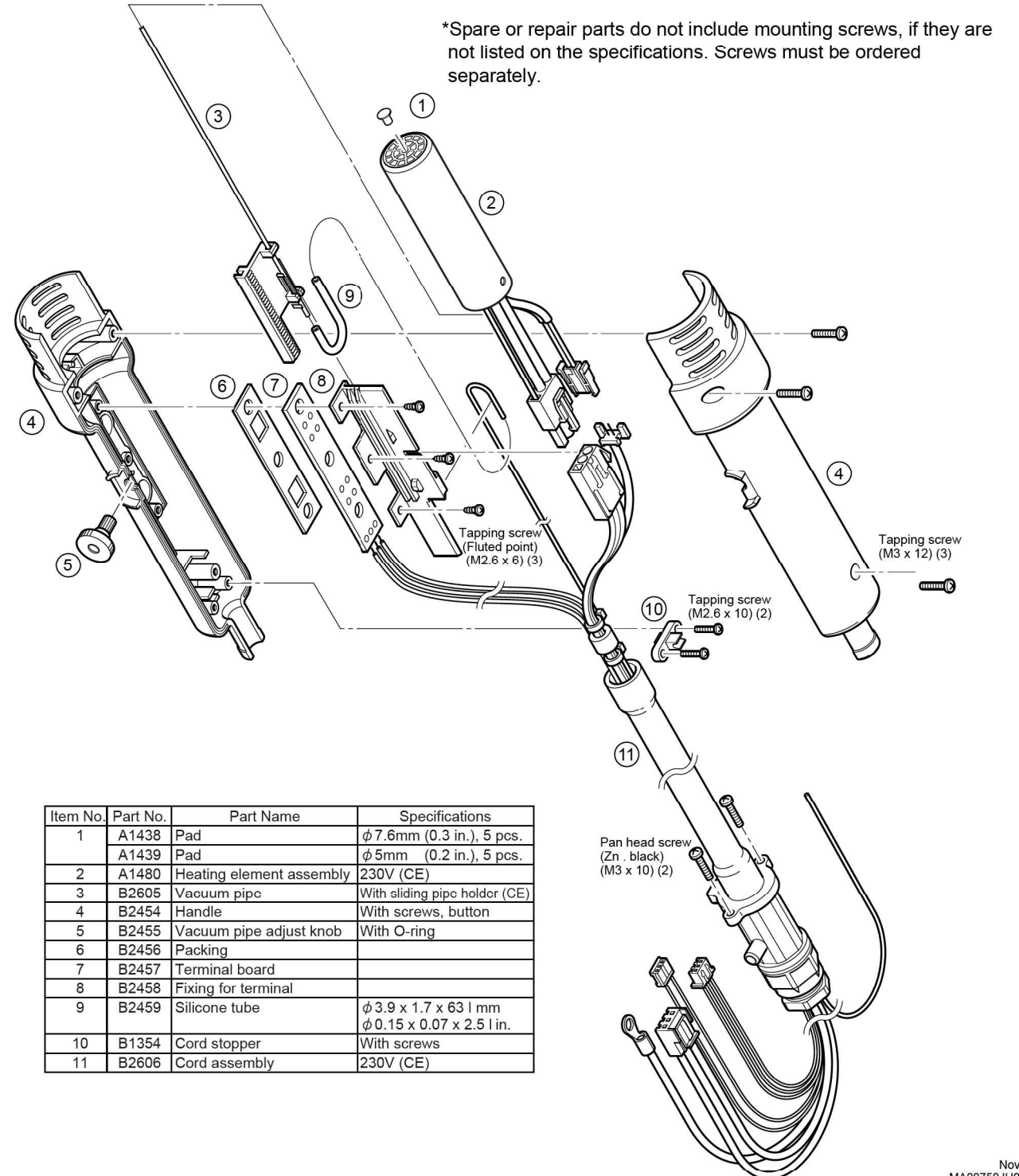

Item No.	Part No.	Part Name	Specifications
1	A1438	Pad	φ 7.6mm (0.3 in.), 5 pcs.
	A1439	Pad	φ 5mm (0.2 in.), 5 pcs.
2	A1480	Heating element assembly	230V (CE)
3	B2605	Vacuum pipe	With sliding pipe holder (CE)
4	B2454	Handle	With screws, button
5	B2455	Vacuum pipe adjust knob	With O-ring
6	B2456	Packing	
7	B2457	Terminal board	
8	B2458	Fixing for terminal	
9	B2459	Silicone tube	φ 3.9 x 1.7 x 63 mm φ 0.15 x 0.07 x 2.5 in.
10	B1354	Cord stopper	With screws
11	B2606	Cord assembly	230V (CE)